

STANDARD FEATURES

1. *Powerclaw* latching system
2. Removable protective web
3. Smart strap
4. Molded seal
5. Pressure equalizer valve
6. Polycarbonate shell
7. Impact bumpers
8. Belt loops
9. Caribiner loop
10. Rubberized interior
11. Removable *Velcro* hand strap



Waterproof Case Operation Manual

Use with
Ranger
Monitor 200
Monitor 1000EC



SPECIFICATIONS

Interior Dimensions	6.7" x 3.8" x 7.9" 170mm x 96mm x 49 mm
Exterior Dimensions	7.4" x 5.1" x 2.6" 188mm x 130mm x 65mm
Weight (empty)	1.1lb .5 kg
Lit Depth	0.5" 13mm
Base Depth	1.4" 36mm
Max Buoyancy	1.7lb 0.8kg
Temperature Range	min -20°F (-29°C) max 140°F (60°C)
Airline Cabin Carry-on	YES
Watertight	YES *(not for use diving)
Warranty	Conditional lifetime guarantee from manufacturer



IPX5 INGRESS PROTECTION -
WATERPROOF



IP6X INGRESS PROTECTION -
DUST PROOF

MATERIALS

Case Sell	Polycarbonate +ABS
Bumpers	TPE
Pins/Hardware	304 Stainless Steel
Purge Valve	Nylon Gore membrane
Strap	Nylon POM
Interior Web	TPE

Push down on the black button. Pull out bottom latch, then flip open top latch.

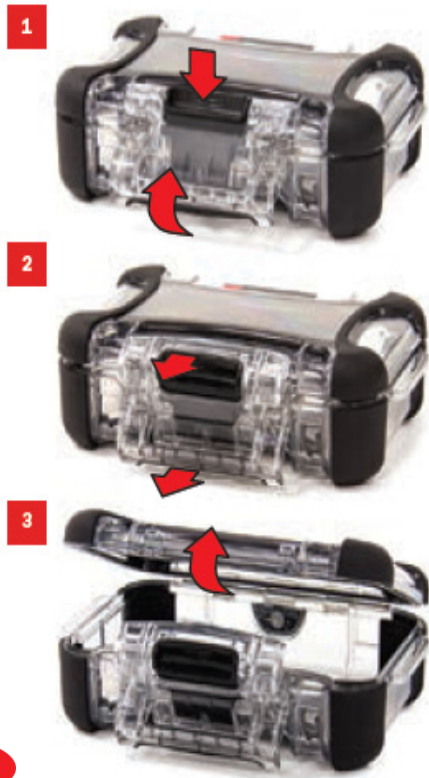

Step 1.

For full view of the monotor screen, the front webbing must be removed.

Remove the 2 screws and bushings and set them aside - instuments fit best in case without these items. Detach the web from the hooks.



Step 2.

Place the webbing in the bottom of the case.



Step 3.

Insert your instrument in rubber boot face up in the bottom half. Close lid and secure latch.



Step 4.